

DIN 1480

Intinzatoare cu sau fara
 carlig si ochi

Acop.: galv. horg.



| d ₁ | M5 | M6 | M8 | M10 | M12 | M16 | M20 | M24 | M30 | M36 |
|----------------|------|-----|-----|-----|-----|-----|-----|-----|-----|-----|
| d ₂ | nom. | 12 | 15 | 18 | 21 | 27 | 34 | 39 | 45 | 55 |
| e | nom. | 19 | 23 | 30 | 34 | 42 | 52 | 60 | 74 | 86 |
| f | nom. | 9 | 11 | 14 | 16 | 20 | 24 | 28 | 34 | 40 |
| h | min. | 6 | 8 | 9 | 11 | 14 | 17 | 20 | 23 | 28 |
| l | nom. | 110 | 110 | 125 | 125 | 170 | 200 | 255 | 255 | 295 |
| m ₁ | nom. | 12 | 15 | 18 | 21 | 27 | 34 | 39 | 45 | 55 |
| m ₂ | max. | 6 | 8 | 9 | 11 | 14 | 17 | 20 | 23 | 28 |

a szabvány nem tartalmazza az adott méretet

| d | simple | carlig-ochi | ochi-ochi | carlig-carlig |
|-----|--------|-------------|-----------|---------------|
| M5 | - | X | X | X |
| M6 | X | X | X | X |
| M8 | X | X | X | X |
| M10 | X | X | X | X |
| M12 | X | X | X | X |
| M16 | X | X | X | X |
| M20 | X | X | X | X |
| M24 | X | X | X | X |
| M30 | X | X | X | X |
| M36 | X | X | X | X |

Piulita inalta de conexiune

m=3d

Acop.: zincare electrolitica

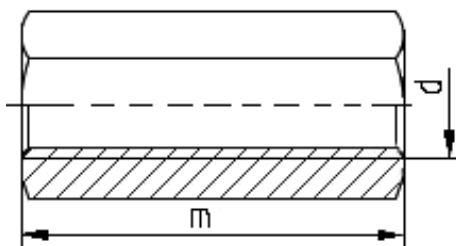

| d | P | m | d | Amb. | |
|-----|------|----|-----|------|-----|
| M4 | 0,7 | 30 | M4 | X | 500 |
| M6 | 1 | 18 | M6 | X | 500 |
| M8 | 1,25 | 24 | M8 | X | 250 |
| M10 | 1,5 | 30 | M10 | X | 200 |
| M12 | 1,75 | 36 | M12 | X | 100 |
| M16 | 2 | 50 | M16 | X | 25 |
| M20 | 2,5 | 60 | M20 | X | 25 |